

PLAT OF SURVEY

of

Lot 85 of Evergreen Estates,

a subdivision located in the Southwest 1/4 of Section 18, Town 3 North,
Range 17 East, Town of LaFayette, Walworth County, Wisconsin.

Surveyed for: **Andrew Makar**
N6148 Spruce Drive
Elkhorn, Wisconsin. 53121

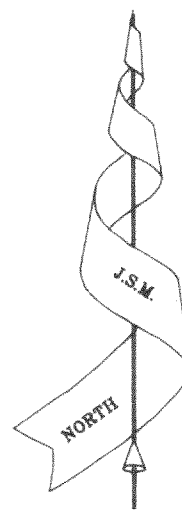

Bearings are referenced to the
plat of Evergreen Estates.

Evergreen Drive

Spruce Lane
(86' wide)

Lot 86

Lot 87

Lot 88

Lot 85
0.493 Acres
21,474 Sq.Ft.

House
N6148

Concrete
Cap
Cover

S 64°18'04" W 234.86
(S 64°15'06" W 235.00)

Lot 84

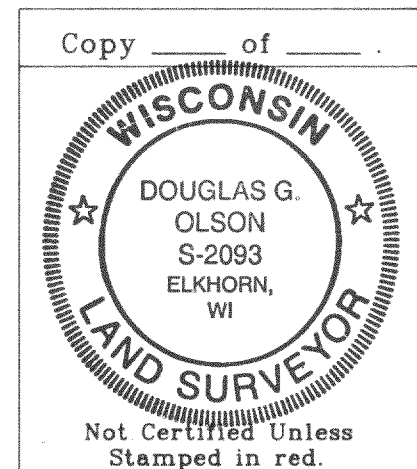
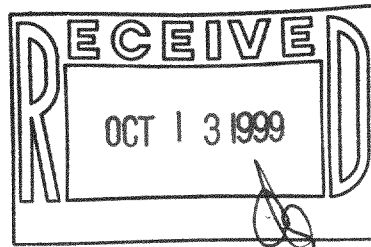

Copyright © 1999 by Jensen & Olson Land Surveying, LLC

All rights reserved. No part of this survey plat may be reproduced or transmitted in any form by any means - graphic, electronic, or mechanical, including photocopying, tracing, or information storage and retrieval systems - without permission in writing from Douglas G. Olson, Jensen & Olson Land Surveying, LLC.

I, Douglas G. Olson, Wisconsin Registered Land Surveyor, do hereby certify that this survey was performed by me, or under my direction in full compliance with the owner's / agent's instructions and Chapter A-E 7 of the Wisconsin Administrative Code "Minimum Standards for Property Surveys"; and that this map is as accurate representation thereof to the best of my knowledge and belief.

Date: May 17, 1999

Douglas G. Olson R.L.S. 2093

Note: This survey plat is not certified unless signed and sealed in red ink.

Note: This survey is subject to Wisconsin lien laws. This Plat of Survey is the notice of intent to file lien. Lien waiver required.

Legend

- Found Iron Pipe
- Recorded Information
- Utility Pedestal
- Concrete Surface
- Asphalt Surface

Jensen & Olson Land Surveying, LLC

45 South Wisconsin Street P.O. Box 322
Elkhorn, Wisconsin. 53121
Telephone: (414) 723-3434
Facsimile: (414) 723-8044

Scale: 1" = 30'



Mapping date: May 17, 1999.
Revisions:

Sheet 1 of 1 Sheets.

Job Reference Number:

1999.060

KE-85

317-463